

Sunday 20th September

- Room SALC1, 09:00-12:30**
S-W5a Modelling and Monitoring of Computer Assisted Interventions (M2CAI)
(<http://campwww.informatik.tu-muenchen.de/M2CAI09>)
- Room SALC1, 14:00-17:30**
S-W5b Geometric Accuracy in Image Guided Intervention
(<http://www.media.queensu.ca/accuracy2009>)
- Room SALC2, 09:00-17:30**
S-W8 Medical Content-based Retrieval for Clinical Decision Support
(<http://www.almaden.ibm.com/cs/projects/aaim/multimodal-decision.html>)
- Room SALC5, 09:00-17:30**
S-W1 Pulmonary Image Analysis
(www.lungworkshop.org)
- Room SALC6, 09:00-17:30**
S-W6 Cardiovascular Interventional Imaging and Biophysical Modelling
(<http://www-sop.inria.fr/asclepios/events/CI2BM09/>)
- Room SALC7, 09:00-17:30**
S-W2 Medical Image Analysis on Multiple Sclerosis (validation and methodological issues,
<http://miams09.inria.fr>)

Thursday 24th September

- Room SALC1, 09:00-17:30**
Th-W11 Systems and architectures for CAI
(<http://smarts.lcsr.jhu.edu/CAI-Workshop-2009>)
- Room SALC2, 09:00-17:30**
Th-W15 Computational Biomechanics for Medicine IV
(<http://school.mech.uwa.edu.au/CBM2009/>)
- Room SALC5, 09:00-17:30**
Th-W13 Diffusion Modelling and the Fibre Cup
(<http://www.cs.ucl.ac.uk/miccai/dmfc>)
- Room SALC 6, 09:00-17:30**
Th-W14 Optical Tissue Image Analysis in Microscopy, Histopathology and Endoscopy (OPTIMHisE)
(<http://ubimon.doc.ic.ac.uk/optm/>)
- Room SALC7, 09:00-17:30**
Th-W9 Augmented environments for Medical Imaging and Computer-aided Surgery (AMI_ARCS)
(<http://campwww.informatik.tu-muenchen.de/AMIARCS09/doku.php>)
- Room SALC9, 09:00-17:30**
Th-T7 Physiological Modelling - An Update on the Physiome Project and Virtual Physiological Human Initiative

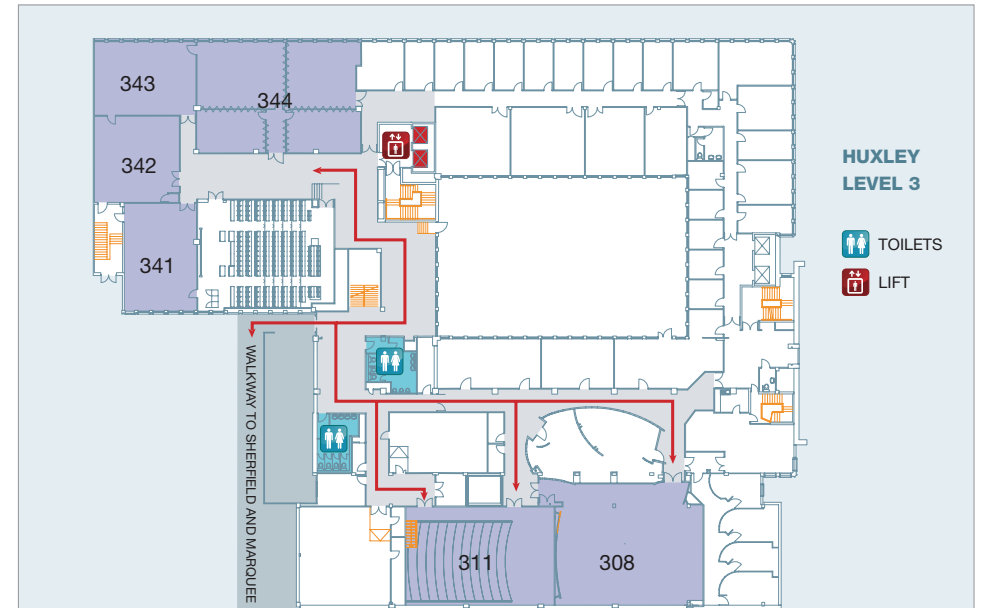

Sunday 20th September

- Room Huxley 308, 09:00-17:30**
S-W4 Probabilistic Models for Medical Image Analysis
(<http://people.csail.mit.edu/pohl/pmmia09.html>).
- Room Huxley 311, 09:00-12:30**
S-T2 Discrete Optimization in Biomedical Image Analysis: Methodologies and Applications
(<http://vision.mas.ecp.fr/miccai09.html>)
- Room Huxley 311, 14:00-17:30**
S-T4 Information theoretic similarity measures for image registration and segmentation
- Room Huxley 342, 09:00-17:30**
S-T3 Medical Robotics and Computer Assisted Intervention
- Room Huxley 343, 09:00-17:30**
S-T1 Trends in High Angular Resolution Diffusion Imaging and Brain Tissue Modelling
(<http://lmi.bwh.harvard.edu/DMRI09/>)

Thursday 24th September

- Room Huxley 308, 09:00-17:30**
Th-W17 3D Segmentation Challenge for Clinical Applications (grand-challenge2009.bigr.nl)
- Room Huxley 311, 09:00-17:30**
Th-T6 Discriminative Learning for Medical Imaging
- Room Huxley 341, 09:00-17:30**
Th-W12 Image Analysis for the Developing Brain
(http://www.radiology.ucsf.edu/bicg/iadb_workshop)
- Room Huxley 342, 09:00-17:30**
Th-W16 MICCAI-GRID, Medical Imaging on Grids, HPC and GPU-based Technologies – Interoperability Highlight on NeuroSciences
(<http://proton.polytech.unice.fr/MICCAI-Grid/>)
- Room Huxley 343, 09:00-12:30**
Th-W10a Modelling networks of connectivity in the brain from functional and structural neuroimaging data
(<http://www.fmrrib.ox.ac.uk/~woolrich/miccai>)
- Room Huxley 343, 14:00-17:30**
Th-W10b Statistical modeling and detection issues in intra- and inter-subject functional MRI data analysis
(<http://collaborations.saclay.inria.fr/parietal/fMRI2009/>)
- Room Huxley 344, 09:00-17:30**
Th-T5 Image-guided Interventions: Technology and Applications



Workshops

- S-W1 **Pulmonary Image Analysis**
(www.lungworkshop.org)
Matthew Brown, Marleen de Bruijne, Bram van Ginneken, Atilla Kiraly, Jan Martin Kuhnigk, Cristian Lorenz, Jamie R. McClelland, Kensaku Mori, Anthony Reeves, Joseph M. Reinhardt
Room SALC5, 09:00-17:30
- S-W2 **Medical Image Analysis on Multiple Sclerosis (validation and methodological issues,**
(<http://miams09.inria.fr>)
Christian Barillot and Louis Collins
Room SALC7, 09:00-17:30
- S-W4 **Probabilistic Models for Medical Image Analysis**
(<http://people.csail.mit.edu/pohl/pmmia09.html>).
Kilian Pohl, Sarang Joshi, William Wells
Room Huxley 308, 09:00-17:30
- S-W5a **Modelling and Monitoring of Computer Assisted Interventions (M2CAI)**
(<http://campwww.informatik.tu-muenchen.de/M2CAI09>)
Gregory Hager, Pierre Jannin, Nassir Navab, Nicolas Padoy
Room SALC1, 09:00-12:30
- S-W5b **Geometric Accuracy in Image Guided Intervention**
(<http://www.media.queensu.ca/accuracy2009>)
Leo Joskowicz, Purang Abolmaesumi, Michael Fitzpatrick
Room SALC1, 14:00-17:30
- S-W6 **Cardiovascular Interventional Imaging and Biophysical Modelling**
(<http://www-sop.inria.fr/asclepios/events/C12BM09/>)
Kawal Rhode, Maxime Sermesant, David Firmin, Nicolas Smith, Tobias Schaeffter, Reza Razavi
Room SALC6, 09:00-17:30
- S-W8 **Medical Content-based Retrieval for Clinical Decision Support**
(<http://www.almaden.ibm.com/cs/projects/aalim/multimodal-decision.html>)
Tanveer Syeda-Mahmood, James Duncan, Henning Müller, Fei Wang
Room SALC2, 09:00-17:30

Tutorials

- S-T1 **Trends in High Angular Resolution Diffusion Imaging and Brain Tissue Modelling**
(<http://lmi.bwh.harvard.edu/DMRI09/>)
Carl-Fredrik Westin, Ragini Verma, Daniel Alexander and Rachid Deriche
Room Huxley 343, 09:00-17:30
- S-T2 **Discrete Optimization in Biomedical Image Analysis: Methodologies and Applications**
(<http://vision.mas.ecp.fr/miccai09.html>)
Nikos Paragios and Nikos Komodakis
Room Huxley 311, 09:00-12:30
- S-T3 **Medical Robotics and Computer Assisted Intervention**
Russell Taylor and Ichiro Sakuma
Room Huxley 342, 09:00-17:30
- S-T4 **Information theoretic similarity measures for image registration and segmentation**
Frederik Maes, William M Wells III and Josien Pluim
Room Huxley 311, 14:00-17:30

Workshops

- Th-W9 **Augmented environments for Medical Imaging and Computer-aided Surgery (AMI_ARCS)**
(<http://campwww.informatik.tu-muenchen.de/AMIARCS09/doku.php>)
PJ "Eddie" Edwards, Kensaku Mori, Christoph Bichlmeier, Jan Klein
Room SALC7, 09:00-17:30
- Th-W10a **Modelling networks of connectivity in the brain from functional and structural neuroimaging data**
(<http://www.fmrib.ox.ac.uk/~woolrich/miccai>)
Mark Woolrich, Saad Jbabdi, Christian Beckmann
Room Huxley 343, 09:00-12:30
- Th-W10b **Statistical modeling and detection issues in intra- and inter-subject functional MRI data analysis**
(<http://collaborations.saclay.inria.fr/parietal/fMRI2009/>)
Bertrand Thirion, Alexis Roche, Philippe Ciuciu and Tom Nichols
Room Huxley 343, 14:00-17:30
- Th-W11 **Systems and architectures for CAI**
(<http://smarts.lcsr.jhu.edu/CAI-Workshop-2009>)
Peter Kazanzides, Rajesh Kumar, Andinet Enquobahrie, Kiyo Chinzei, Oliver Burgert
Room SALC1, 09:00-17:30
- Th-W12 **Image Analysis for the Developing Brain**
(http://www.radiology.ucsf.edu/bicg/iadb_workshop)
Colin Studholme and Francois Rousseau
Room Huxley 341, 09:00-17:30
- Th-W13 **Diffusion Modelling and the Fibre Cup**
(<http://www.cs.ucl.ac.uk/miccai/dmfc>)
Matt G Hall, Ivana Drobnjak, Hubert Fosteijn, Phil Cook
Room SALC5, 09:00-17:30
- Th-W14 **Optical Tissue Image Analysis in Microscopy, Histopathology and Endoscopy (OPTIMHisE)**
(<http://ubimon.doc.ic.ac.uk/optm/>)
Daniel Elson and Nasir Rajpoot
Room SALC 6, 09:00-17:30

- Th-W15 **Computational Biomechanics for Medicine IV**
(<http://school.mech.uwa.edu.au/CBM2009/>)
Karol Miller and Poul Nielsen
Room SALC2, 09:00-17:30
- Th-W16 **MICCAI-GRID, Medical Imaging on Grids, HPC and GPU-based Technologies – Interoperability Highlight on NeuroSciences**
(<http://proton.polytech.unice.fr/MICCAI-Grid/>)
Giovanni B. Frisoni, Chiara Barattieri and David Manset, with Jérôme Revillard, Johan Montagnat and Silvia D. Olabarriaga
Room Huxley 342, 09:00-17:30
- Th-W17 **3D Segmentation Challenge for Clinical Applications**
(grand-challenge2009.bigr.nl)
Theo van Walsum, Reinhard Hameeteman, Leo Joskowicz, Maria A. Zuluaga, Nobuhiko Hata, Gabor Fichtinger, Vladimir Pekar, Perry Radau
Room Huxley 308, 09:00-17:30

Tutorials

- Th-T5 **Image-guided Interventions: Technology and Applications**
Kevin Cleary, Terry Peters, Purang Abolmaesumi, Wolfgang Wein, Ameet Jain and Martin Groher
Room Huxley 344, 09:00-17:30
- Th-T6 **Discriminative Learning for Medical Imaging**
Zhuowen Tu, Adrian Barbu and Kevin S. Zhou
Room Huxley 311, 09:00-17:30
- Th-T7 **Physiological Modelling - An Update on the Physiome Project and Virtual Physiological Human Initiative**
Gabor Szekely
Room SALC9, 09:00-17:30

